

I:\Highways and Transport\Projects\Highway Projects\A4 Newbury to Calcot Cycle Improvements\CAD Contract Drawings\Section 1 - Newbury to Thatcham (Phase 1).dwg

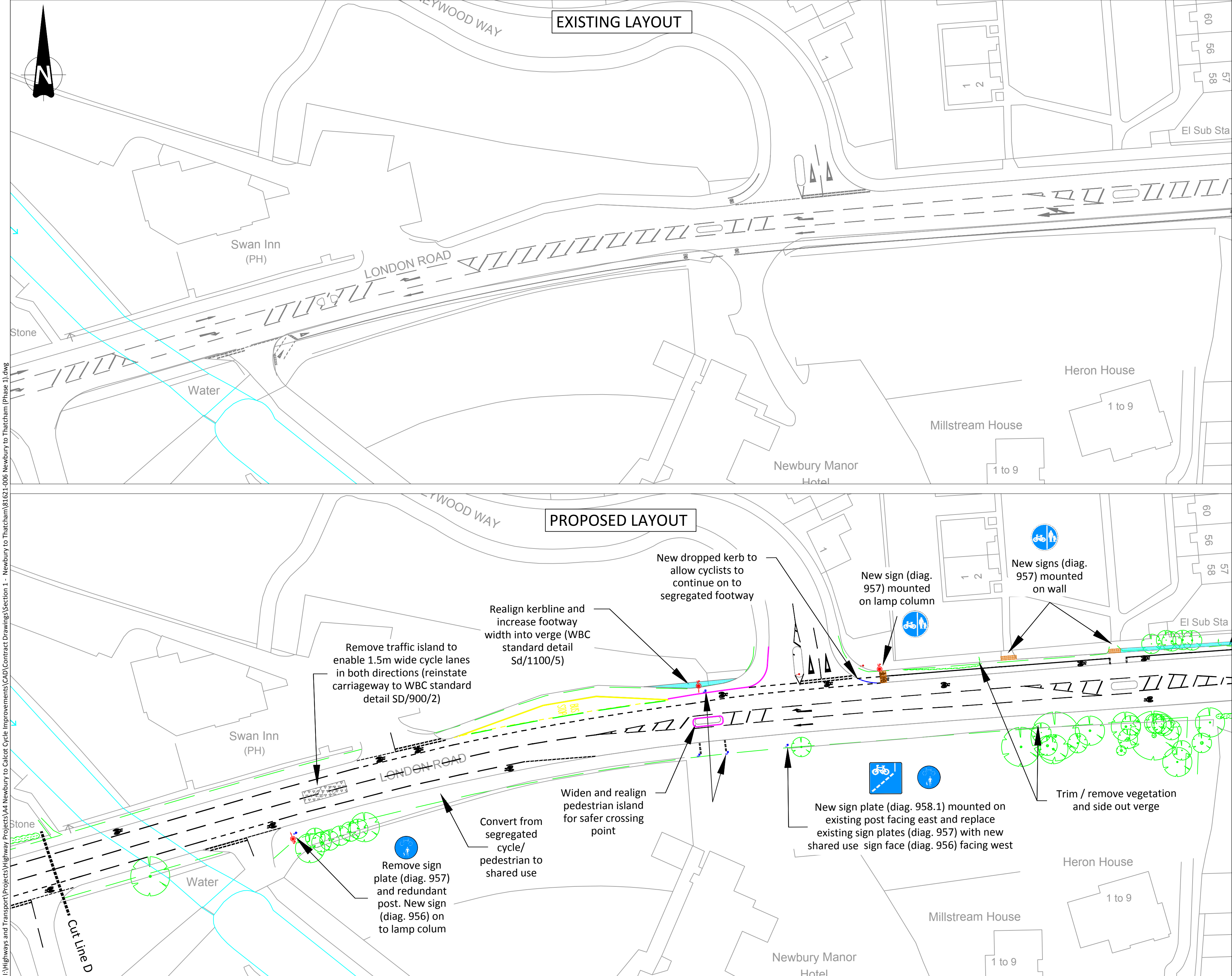

- KEY**
- Dropped kerb
 - New kerbline
 - Footway widening
 - Carriageway resurfacing
- NOTES**
- 1) All dimensions are shown in metres unless shown otherwise.
 - 2) This drawing shows a proposed option and is subject to change following the location, depth and height of existing utility services.
 - 3) WBC Standard Details must be adhered to at all times unless specified by the Overseeing Organisation.
 - 4) Prior to any excavations the contractor will establish the location of existing utility services.

REV	DESCRIPTION	DR	AU	REV DATE

Status

West Berkshire Council

Transport & Countryside | Council Offices
Market Street | Newbury | RG14 5LD

Project Title

NCN422 Section 1 Phase 1
Cycling Improvements

Drawing Title

Swan Inn PH to Dorneywood
Way (Pg5 of 5)

Date	Drawn By	Checked By	Paper Size	Drawing Scale
26/09/17	JBK	NS	A2	1:500

Drawing Number	Revision
81621-004-05	B